

Digital Mug Heat Press Manual

Model No.: MP-110A/B/C/D

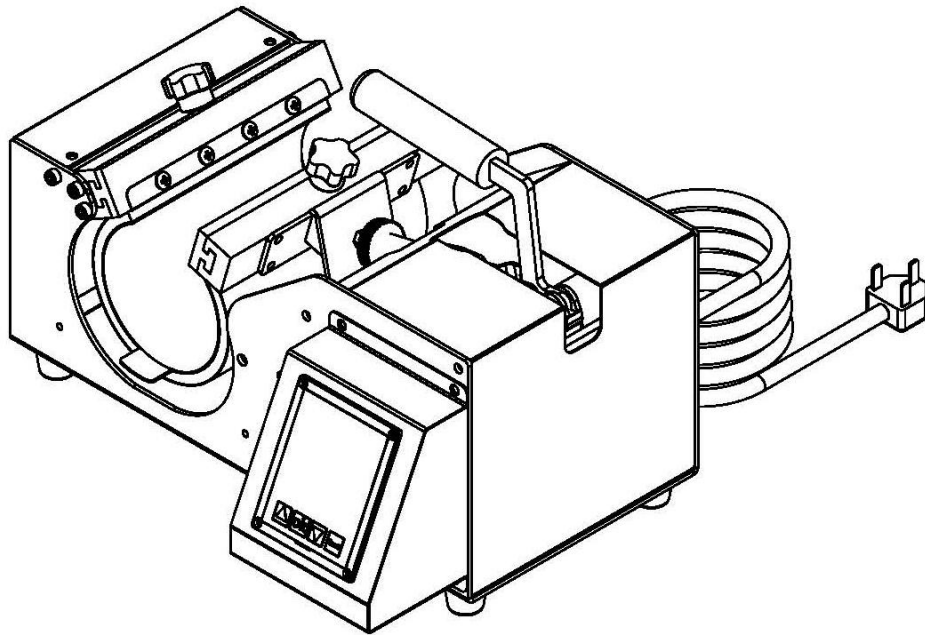

CONTENTS

I. Assembly Drawing	-----2
II. Technical Parameters	-----2
III. Explosion View	-----3
IV. Maintenance	-----4
V. Trouble Shooting For Transfer Print Quality	-----4
VI. Circuit Diagram	-----4
VII. Operation Process	-----5-6

I. Assembly Drawing

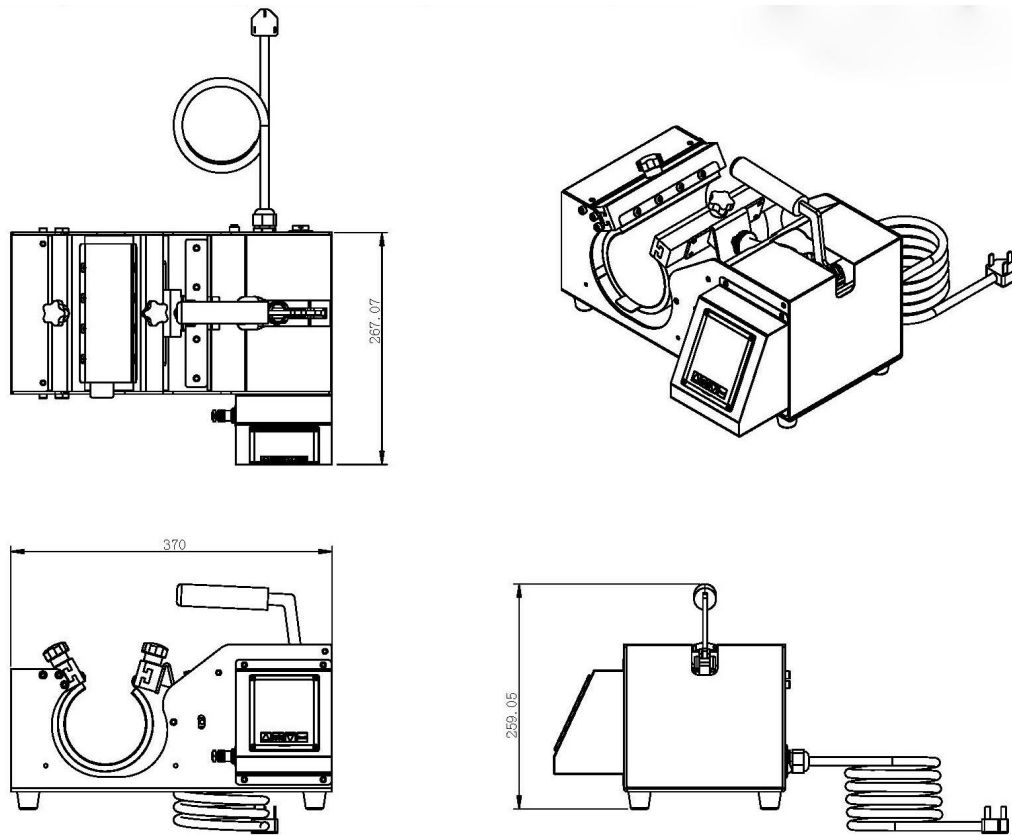

II. Technical Parameters

1. Model No.: MP-110A/B/C/D
2. Mug Heater Size: Dia.6-7.5cm for 6oz,9oz,10oz etc Mug
Dia.7.5-9.0cm for 11oz,15oz etc Mug
12oz/17oz Latte Mug Heater
3. Printable Articles Max Size: $\phi 100 \times 120$ mm
4. Voltage: 220V/1Phase; 110V/1Phase
5. Power: 130W
6. Recommend Setting: 30~280s; 180~200°C
Time Range: 0~999s
Maximum Temp: 225 C°
7. Packing Size: 47.5*35.5*31cm for MP-110B
8. Gross Weight: 9.70kg for for MP-110B

III. Explosion View

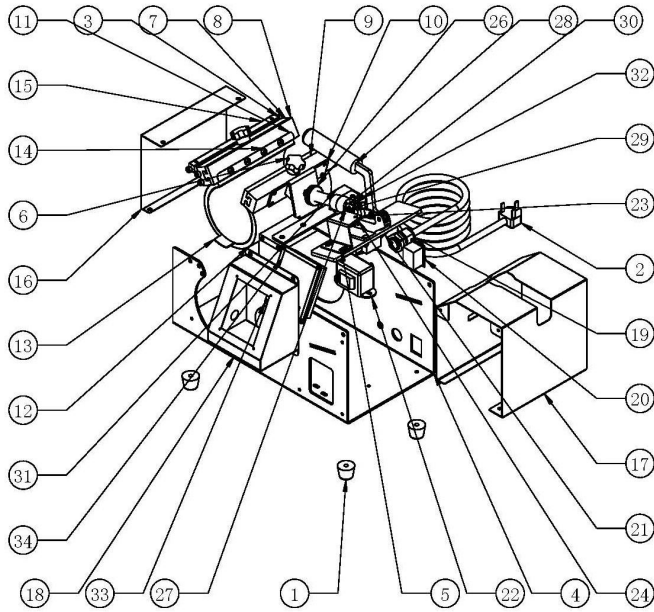

Serial No.	Part Name	Qty
1	Machine Base	4
2	Power Cord	1
3	GB_FASTENER_SCREWS_ HSHCS M5X16-N	6
4	Frame	1
5	Quick clamp mounting plate 1	1
6	M6 hand wheel screw	2
7	Slider fixture	1
8	Aluminum slider	2
9	Slider fixing plate	1
10	Slider fixed bending plate	1
11	Beer mug coaster stainless steel tape	1
12	Beer mug coaster silicone	1
13	Beer mug coaster heating pad	1
14	M5 screw	8
15	180 pole	1
16	Decorative board	1

17	Parts machine assembly	1
18	External temperature control sheet	1
19	Mirror power cord	1
20	Rocker switch	1
21	Circuit breaker 20A	1
22	Transformer	1
23	Limit switch fixing plate Z	1
24	Limit switch	1
25	Four-core aviation plug	1
26	Adjustment screw	1
27	Quick clip base	1
28	Quick grip handle	1
29	Quick clip action bar	2
30	Quick clip axis	1
31	Positioning member	1
32	Positioning platen	1
33	New vertical controller shell	1
34	Panel for new controller	1

IV.Maintenance

1. In order to prolong the machine service life, please add the lubrication oil on the joints regularly .
2. Turn off the power before changing spare parts. In order to ensure the accuracy of the parameter of GY-09 controller, please re-set the time and temperature.
3. To avoid damage, please keep the heaters well after change the spare parts.

V.Trouble shooting for transfer print quality

1. After changing mug heater, time and temperature showing become abnormal:
Solution: Reset time/temperature according to the manual
2. If the color is not as bright as photo after printing, please try below ways:
Solution: A. Adding transfer time. B. Increasing transfer temperature.
3. If the print color is too brown or the transfer paper is almost burnt:
Solution: Please reduce the setting temperature.
4. If print color is different/ partial transfer effect is not good enough:
Solution: A. Increase the pressure. B. Extend the transfer time. C. Change the sublimation paper.
5. If the machine is getting abnormal, please contact us to solve the problems.

VI.Circuit Diagram

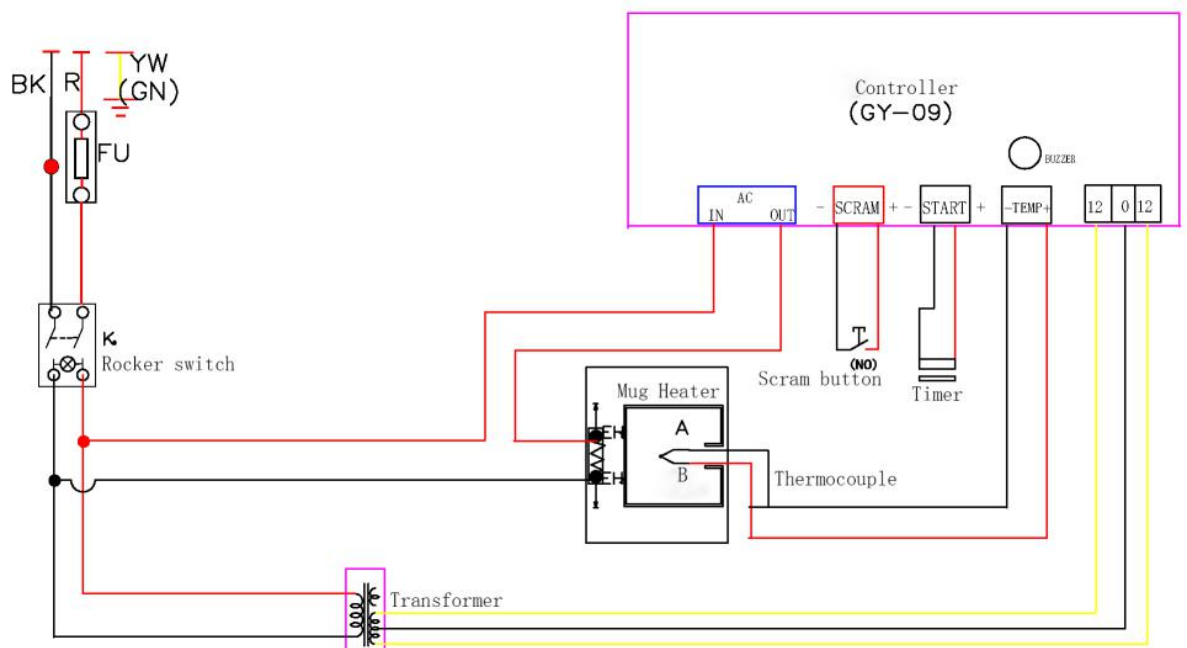

VII.GY-09 Controller Operating Process

1) Main interface as below picture.

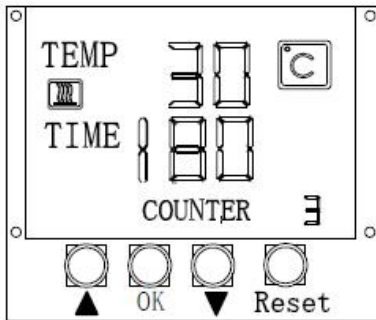

2) Press “OK” button to adjust temperature, press “▲▼” for temperature adjusting. (Celsius degree adjusting range is 0~230°C, Fahrenheit degree adjusting range is 0~446°F)

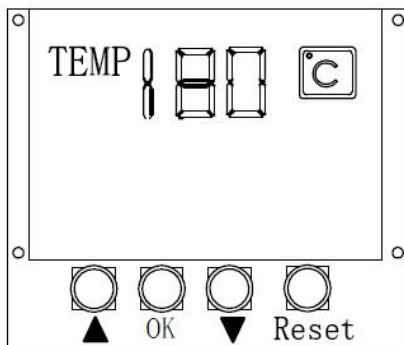

3) Press “OK” button to enter TIME setting, press”▲▼” for time adjusting. (Time adjusting range is 1-999 S)

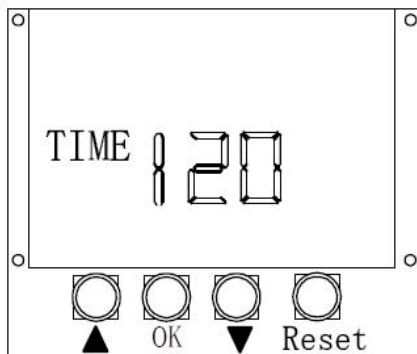

4) After finish the setting, press “OK” button, then back the main interface, the machine start to heating up.

5) Please repeat step 2 to step 4 to adjust the parameters if needed, when machine is under heating-up situation.

6) Press down the heating platen to start and trigger the digital controller, the time will begin to count down. When the time is left to 3 seconds, the buzzer will warn. When the time is over, the transfer process is complete.

7) Long press "OK" button for 4 to 5 seconds, can enter to the engineering mode:

P-1 mode: Press "▲▼" to switch Celsius degree/Fahrenheit degree.

P-2 mode: Temperature difference calibration mode (range-50~+50)

E.g.: Set 180°C as target, when the display shows 180°C, while the real average temperature of heating platen is 174°C. That is to say, the temp difference is 6°C, it needs to decrease the display temperature by 6°C.

Suppose the current P-2 mode shows "10" after you enter, then you need to press the "▲▼" and change "10" to "04". (namely decreased 6°C already).

P-3 mode: Setting for starting to intermittent heating how much temperature in advance (range 1~20)

E.g.: You could set a temperature value that you want to enter to constant temperature before it reach the setting temperature. For example, the setting temperature is 180C and P-3 is 10°C, then when the temperature reaches 170°C, it will enter the constant temperature mode, heating and pause in cycle to avoid overheat.

P-4 mode: Intermittent heating mode (range 1~9)

P-5 mode: Constant heating mode (range 1~9)

P-6 mode: Sleep mode, automatic shut-off the machine after how many time without any operation (0~240 minutes)

P-7 mode: Count down mode, there are two modes, mode 1 is start to count down once the heat platen is pressed down, mode 2 is start to count down only when the temperature reach the setting value and the heat platen is pressed down.

Important Notice: This operation is recommended under the guidance of professional staff, Please don't change any setting without consulting our engineers.