

COS-HOBBY Digital Mug Press Manual

Model No.: COS-10A/B/C/D

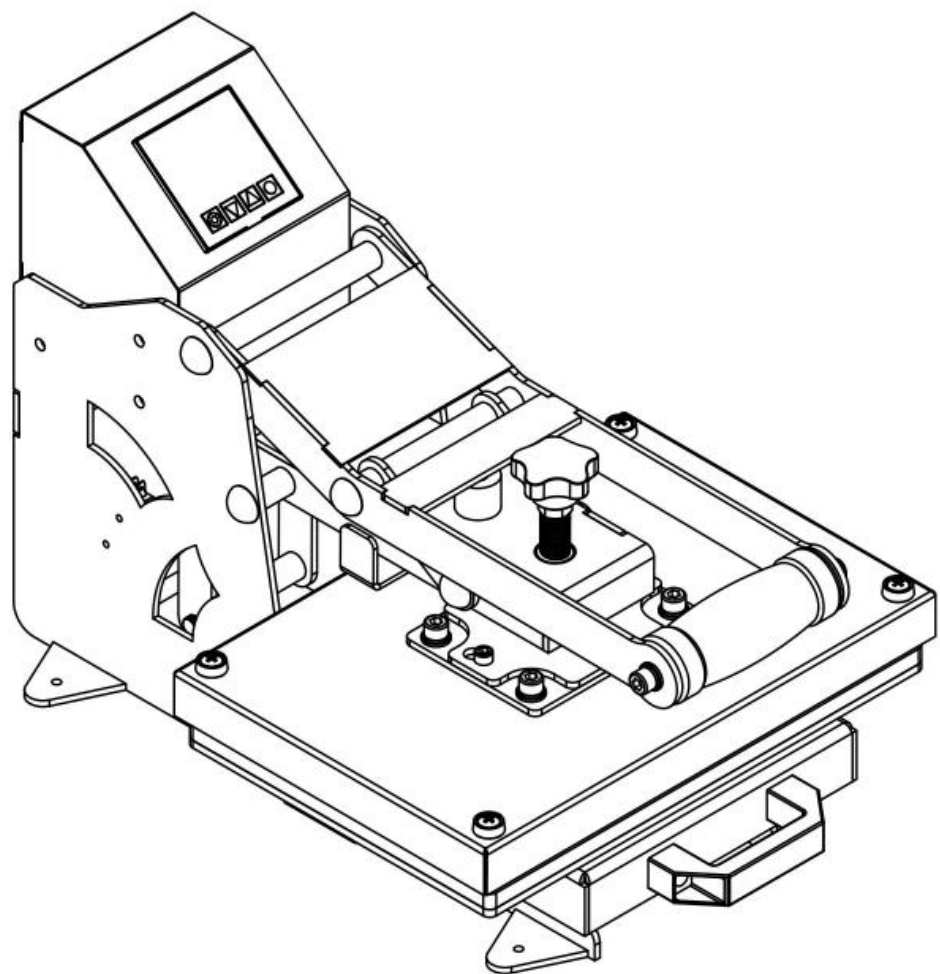

I. Technical Parameters

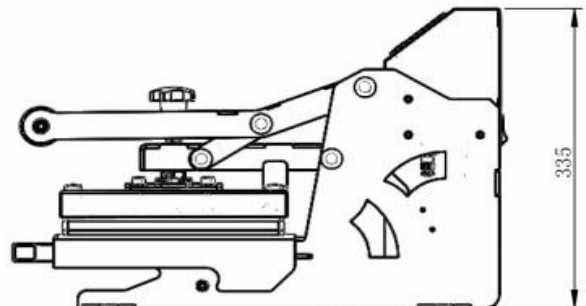
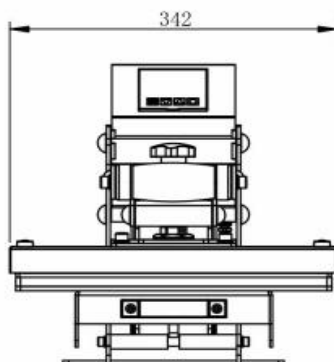
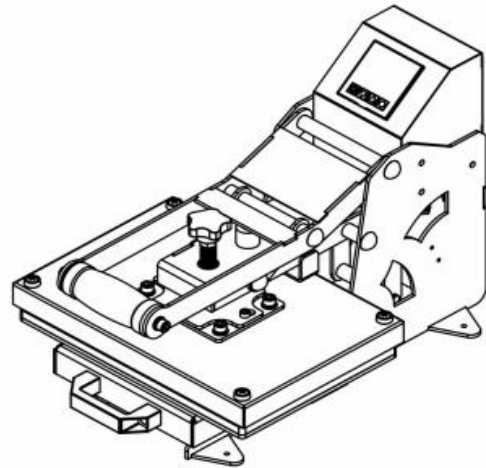
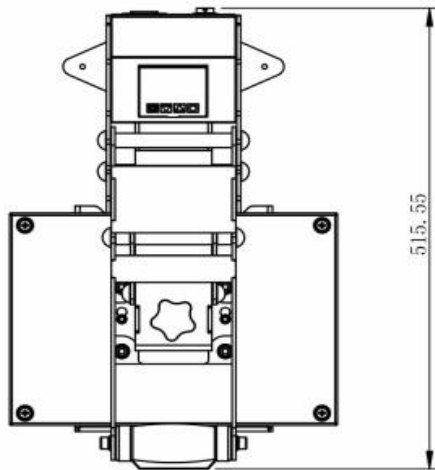

1. Model: COS-HOBBY heat press machine
2. Machine size:515.5*342*335MM
3. Transfer MAX size:220*320*5MM
4. Voltage:120V single phase
5. Power:800W
6. Temperature Time Range:0-999
Set time:30-280s,Temp:180-210°C
7. Packing size:615*415*440mm

II. Explosion View

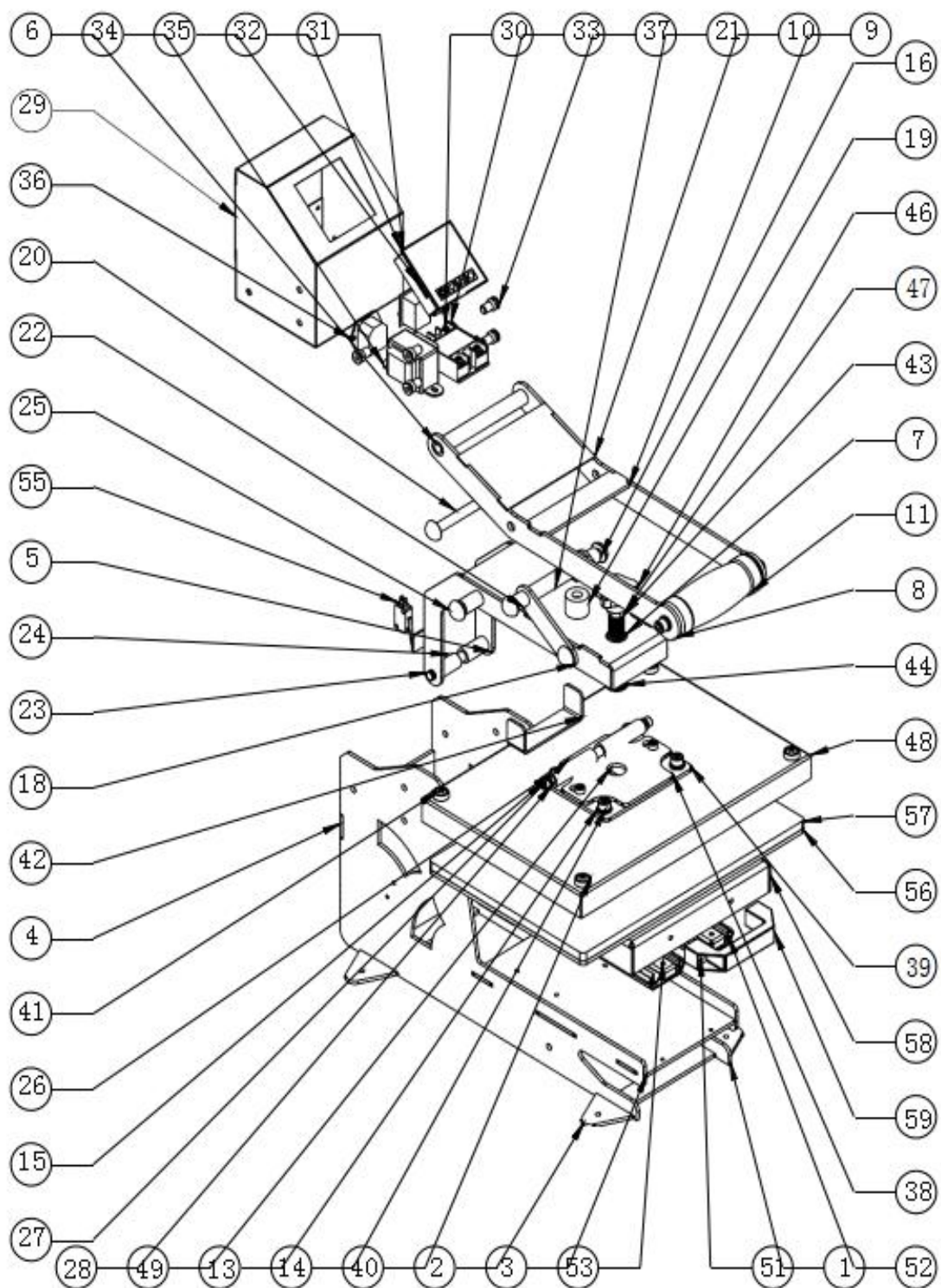

NO	Spare part name	Qty	NO	Spare part name	Qty
1	Rack left and right side panels COS	2	33	Small four-core aviation plug	2
2	Foot fixing plate COS	2	34	New transformer	1
3	Base plate fixing plate COS	1	35	Rocker switch	1
4	Rack connector COS	1	36	Suffix	1
5	Boom COS	1	37	BlindnietmutterM5_geschl	6
6	Boom welded casing COS	2	38	Adapter plate 1COS	1
7	M16 nut	1	39	Heating plate adapter plate COS	1
8	Left and right handles COS	2	40	Insulated plastic ring	4
9	Handle welded connecting plate COS	1	41	GB_CROSS_SCREWS_TYPE1 M6X8-8 H type-N	4
10	Electric box fixing plate COS	1	42	Anti-sway COS	1
11	EVA handle	1	43	M16 Adjustment screw 5	1
12	128 handle shaft	1	44	Adjustment nut 24	1
13	GB_FASTENER_WASHER_SMWC 8	6	45	40 gasket	1
14	GB_FASTENER_WASHER_CSLW 8	8	46	M10 adjustment hand wheel 9	1
15	GB_FASTENER_SCREWS_HSHCS M6X12-N	10	47	GB_FASTENER_NUT_SNAB1 M10-N	1
16	Handle pin COS	1	48	230305 cover COS	1
17	Boom pin COS	1	49	Die-casting heating plate 230330	1
18	Connecting piece COS	2	50	2030 heating tube COS	1
19	Limit excellent glue COS	1	51	Pulling the slide rail	2
20	Column latch COS		52	Slide intermediate plate	2
21	Connecting piece isolation race steel length COS	1	53	Rail center plate	2
22	Connecting piece isolation race steel short COS	1	54	GB_FASTENER_SCREWS_HSFP M6X16-N	2
23	Spring fixing pin COS	1	55	Limit switch	1
24	Spring isolation sleeve COS	2	56	Base plate 230305COS	1
25	10 rivets		57	230305 silicone pad COS	1
26	Spring front fixing pin COS	1	58	Base plate drawing board COS	1
27	Front spring isolation race steel COS	2	59	Aluminum alloy handle	1
28	GB_ROUND_WASHERS_TYPE7 6 2				
29	Electric box bending panel COS1	1			
30	Relay	1			
31	New temperature control table housing panel.SLDDRW	1			

III. Maintenance

1. In order to prolong the machine service life, please add the lubrication oil on the joints regularly .
2. Turn off the power before changing spare parts. In order to ensure the accuracy of the parameter of GY-10 controller, please re-set the time and temperature.
3. To avoid damage, please keep the heaters well when change the spare parts. V. Trouble Shooting For Transfer Print Quality.

V. Trouble shooting

1. After changing heat platen, time and temperature showing become abnormal:
Solution: refer to manual and make time/temperature reset.
2. If the color is not as bright as photo after printing, please try below ways:
 - a. adding transfer time
 - b. increasing transfer temperature.
- 3.If the print color is too brown or the transfer paper is almost burnt: need to reduce the setting temperature.
4. If print color is different/ partial transfer effect is not good enough: the pressure is not enough / or not pressed long enough / or poor quality transfer paper.
5. If machine gets not working, please contact supplier as soon as possible to get technical support.And then deal with machine according to supplier's guidance

IV. Circuit Diagram

