

INSTRUCTION MANUAL

MODEL:FF-4503A

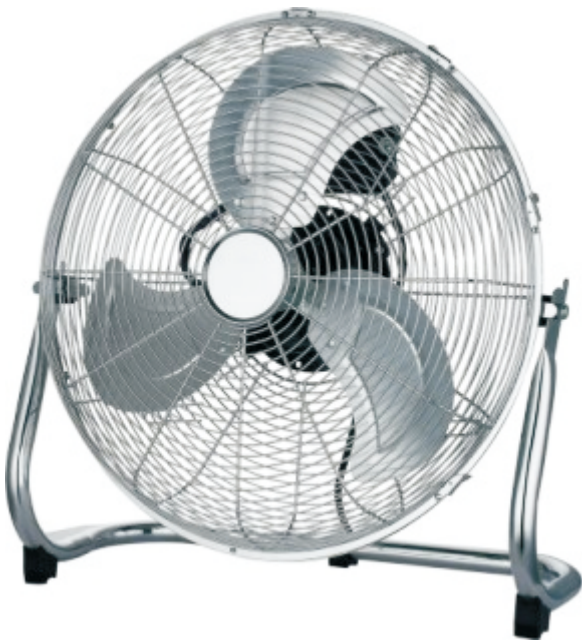

Read carefully and retain this instruction for safe operation.



Instructions for safe operation

1. Fan should be used only at rated voltage..
2. Never insert fingers or any other object through the fan guard when fan is running.
3. Unplug when not in use, or when moving fan from one location to another, and before putting on or taking off parts and before cleaning.
4. Need to check the power cord and plug is damaged regularly. If it’s damaged, must replace the power cord or plug by the manufacturer or a qualified expert/agency to avoid hazards.
5. Do not put your fingers through the openings. Do not let children put any objects into the front case.
6. Do not use this fan outside or in a damp area such as bathroom.
7. Do not place the electrical cord under a cover. Do not overlay the cord with little covers or such element. Place the cord in an area where there is no risk to stumble.
8. The fan must always be unplugged when not operating. To unplug the heater, all the switches must be on the position “OFF”, and then the plug could be disconnected.
9. Do not operate the fan in an area where gasoline is used or stocked, painting or such flammable liquids.
10. If you need to move the fan, switch off and unplug it.
11. No part of this fan must be replaced by the user.
12. The fan should not be opened up by the user.
13. Be sure not to allow water or other liquid to enter the inside of motor.
14. If the supply cord is damaged the fan must stop to use and be replaced by a qualified electrician.
15. The fan must be earthed.
16. The fan must be placed on a flat surface.
18. The appliance is not intended for use by persons (including children) with reduced physical, sensory or mental capabilities, or lack of experience and knowledge, unless they have been given supervision or instruction concerning the use of the appliance by a person responsible for their safety. Children should be supervised to ensure that they do not play with the appliance.

Parts description:

1. SCREW
2. FRONT GUARD
3. GUARD CLIPS
4. BLADE
5. SET SCREW
6. NUT
7. SQUARE BOLT
8. REARGUARD
9. MOTOR
10. SCREW
11. PLASTIC BEARER
12. LOCKNUT
13. SCREW
14. TUBE BASE
15. POWER CORD
16. CONTROL BOX
17. WASHER
18. NUTS
19. HANGING HOOK
20. SCREW

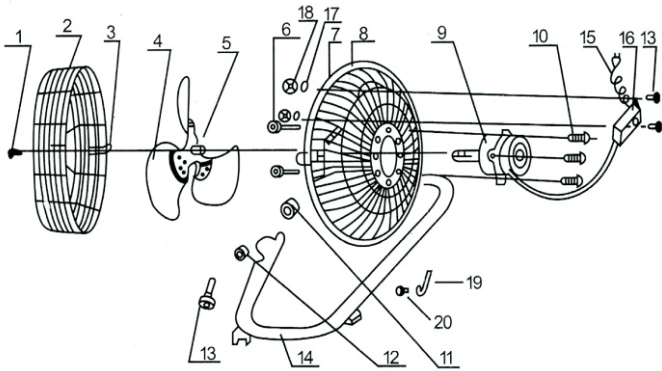

Operating Instructions:

1. Check that mains voltage complies with the voltage stated on the product.
2. Adjust the speed by pressing the switch:  
0-Stop    1-Low    2-Medium    3-High
3. Adjust the tilt angle by moving the fan guard.

**WARNING: This appliance must be earthed.**

Maintenance Instructions:

1. Before cleaning turn the fan off and unplug from the power supply.
2. To clean the fan use a soft cloth to wipe off any dust. If the fan is very dirty use a damp cloth and wipe dry. Do not use any cleaning detergents, sprays or other chemicals, as they will damage the fan.
3. Store the fan in the original packing in a ventilated dry area.
4. The motor bearings are permanently sealed and do not require additional lubrication.
5. Do not allow water to drip on or enter the fan housing.